

D SERIES DOUBLE REDUCTION, WORM GEAR REDUCERS DIMENSIONS

OHIO GEAR

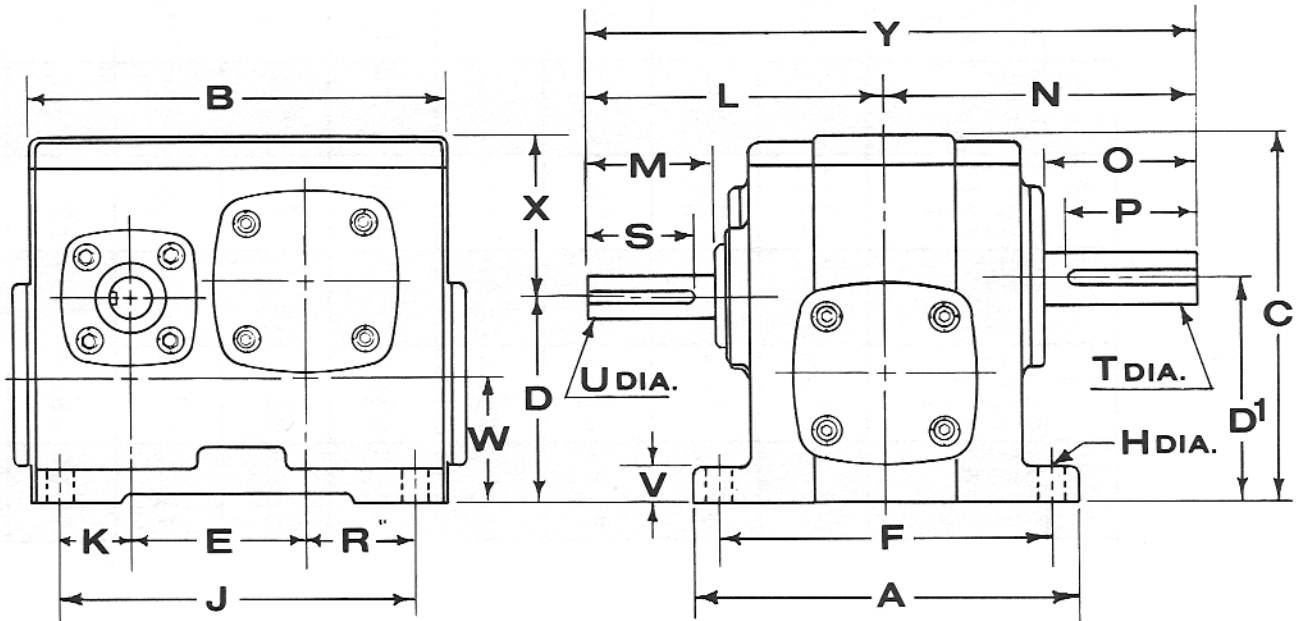

ASSEMBLIES

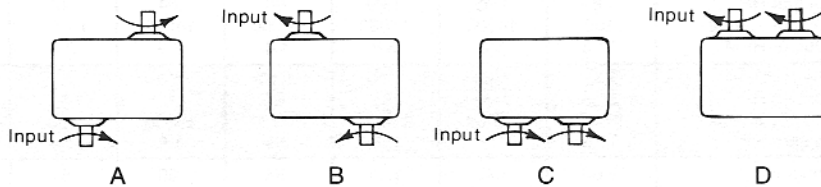

Shafts may be rotated in either direction—arrows merely indicate relative rotation. When ordering, specify assembly desired.

REDUCER DIMENSIONS

Unit	High Speed Shaft														Low Speed Shaft											
	A	B	C	D	D ₁	E	F	H	J	K	R	V	W	X	Y	L	M	S	U	K.W.	N	O	P	T	K.W.	
D-1	5½	5⅝	5⅞	3½	3½	2½	4¾	1⅜	5⅝	1	1⅝	½	1⅞	1⅜	8¾	4¼	1⅜	1⅝	⅝	⅜	3/16 x 3/32	4½	2	1⅞	¾	3/16 x 3/32
D-2	6	7	6½	3.40	4⅞	3	5⅝	1⅜	5¾	1	1¾	9/16	2⅞	2⅞	8⅞	4⅝	2	1⅞	⅞	3/16 x 3/32	4⅞	2⅞	1¾	1	¼ x ⅞	
D-3	6½	7⅞	7⅞	3½	4½	3⅝	5½	1⅞	6¼	1⅞	2⅞	⅝	1⅞	4⅞	10⅞	5¼	2⅞	1¾	⅞	3/16 x 3/32	4⅞	2⅞	1⅞	1	¼ x ⅞	
D-4	9	10	10	5⅞	6½	4	7¾	1⅞	8½	1⅞	3⅞	¾	3	4⅞	12⅞	6	2⅞	1⅞	⅞	3/16 x 3/32	6⅞	2¾	2¼	1½	3/8 x 3/16	
D-5	11	13⅞	14⅞	7¼	9⅞	5½	9	2⅞	10	2⅞	3⅞	1	4	7⅞	14¾	7¼	2⅞	2¼	¾	3/16 x 3/32	7⅞	3	2⅞	2	½ x ¼	
D-6	11½	16⅞	16⅞	8.583	10½	7⅞	9½	2⅞	14⅞	1⅞	5⅞	1½	4¼	7.854	17½	8½	3⅞	3½	1	¼ x ⅞	9	4	3½	2½	⅝ x ⅞	